

# SERVICE MANUAL

## Sniper 2R

- ◆ Exploded View
- ◆ Part List
- ◆ Circuit Diagrams
- ◆ Wiring Diagrams



No.	Revise Area	Revised Content	Date
1			
2			

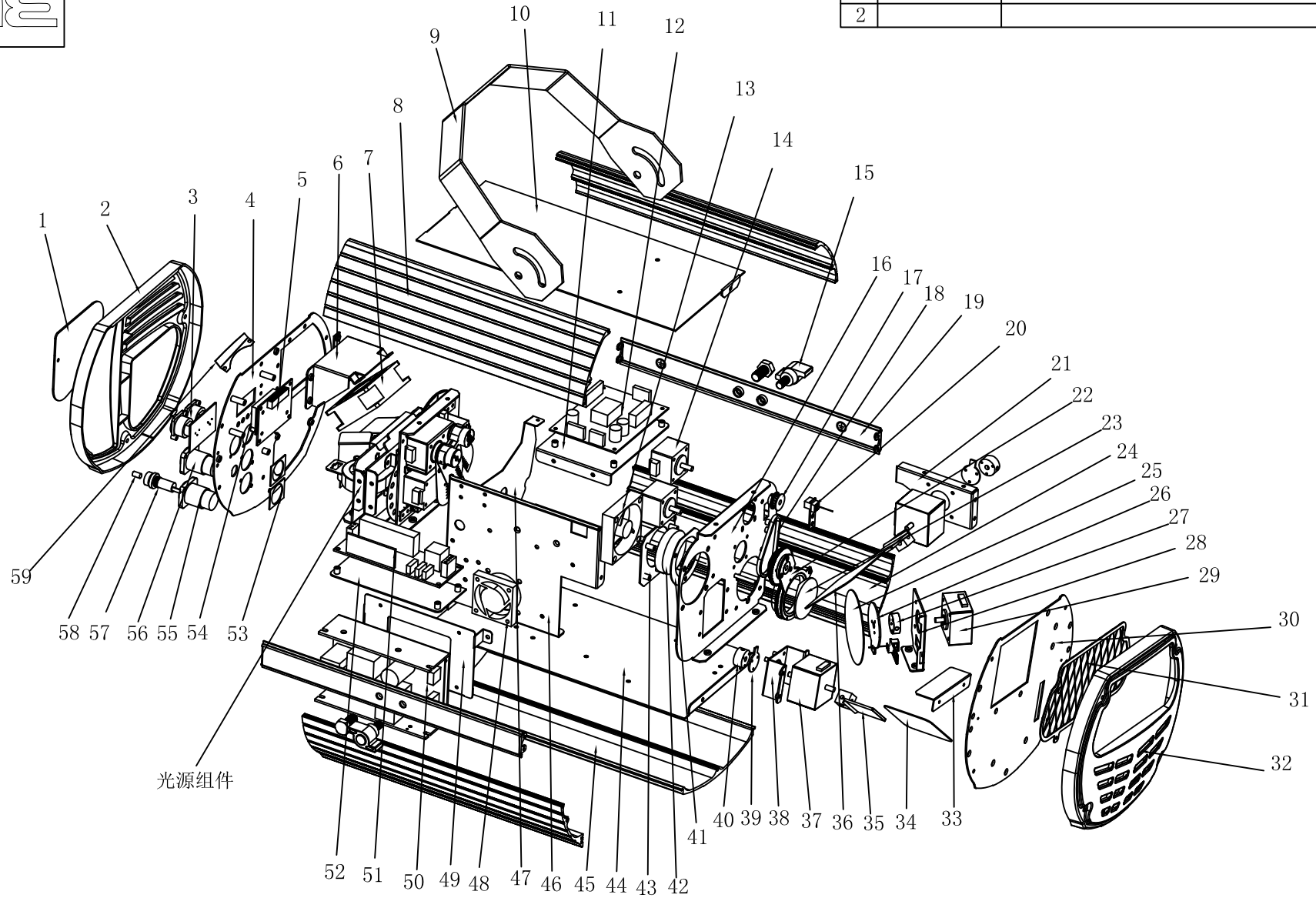

Original Controlled

Copy Controlled

Stamp

Item NO.

Item Name

ELA-LS2R

Approval

Verification

Charting

Tale

20140417

Exploded Diagram

Parts NO.

Drawing NO.

Edition

Total Page

Seq:

Version

A

1

1

Ver1.1

ALL

YF-XP2-14006-01-00



# Parts list

Model:	ELA-LS2R
Date:	20140515
Version:	A
Page 1	

Seq	Part No.	Part Name
1.	4031160040	Back plate of lamp
2.	3005002157	Plastics back cover
3.	2010203825	5 pin DMX signal board
4.	4031160130	Back board
5.	2010143506	Display PCB
6.	4031160100	Fixed plate of fan
7.	3014001167	DC ball fan
8.	4031160370	Aluminium 3
9.	4031160080	Hanger
10.	4031160090	Top cover plate
11.	4031160220	Fixed plate of main PCB
12.	2010204088	Main PCB
13.	3014001144	DC ball fan
14.	3010000018	Stepping Motor
15.	3026013022	S handle
16.	4031160140	Fixed plate of prism
17.	3002000272	Belt wheel 2
18.	3022000151	Belt for prism
19.	4031160250	Side board
20.	2010088701	Sensor board D2
21.	4031160030	Fixed plate of mirror
22.	3002000861	Prism holder
23.	3015000216	Glass
24.	4031160380	Aluminium 4
25.	3016000139	Reflector 3
26.	4031160290	Flitch of rotating mirror
27.	3002001697	Rotating wheel of mirror
28.	4031160280	Fixed plate of rotating mirror
29.	3010000016	Stepping motor
30.	4031160160	Front plate
31.	4031160300	Lens net
32.	3005002156	Plastics front cover
33.	4031160320	Barn doors
34.	3016000137	Reflector 1
35.	3002001696	Mirror holder
36.	3016000138	Reflector 2

Seq	Part No.	Part Name
37.	3010002003	Stepping motor
38.	4031160230	Fixed plate of motor
39.	4031160340	limit control board
40.	3002001695	Positioning wheel
41.	4031160190	Squash of lens
42.	3015000190	Cemented lens
43.	4031160180	Fixed plate of lens
44.	4031160070	Base board
45.	4031160360	Aluminium 2
46.	4031160110	Partition
47.	4031160310	Barn doors
48.	3014001154	DC ball fan
49.	4031160270	Fixed plate of power supply
50.	2210006900	Power supply
51.	3007015056	Electronic ballast
52.	4031160170	Driver fixed plate
53.	4041690080	Fixed plate of powercon
54.	3005000885	Glass of display screen
55.	3003000260	Powercon socket
56.	3003000261	Powercon socket
57.	3020000026	Fuse base
58.	3019000062	Delay fuse
59.	4031160350	Air deflector
60.		
61.		
62.		
63.		
64.		
65.		

受控正本	受控副本	单位章	批准	
			审核	
			编制	黎景雄

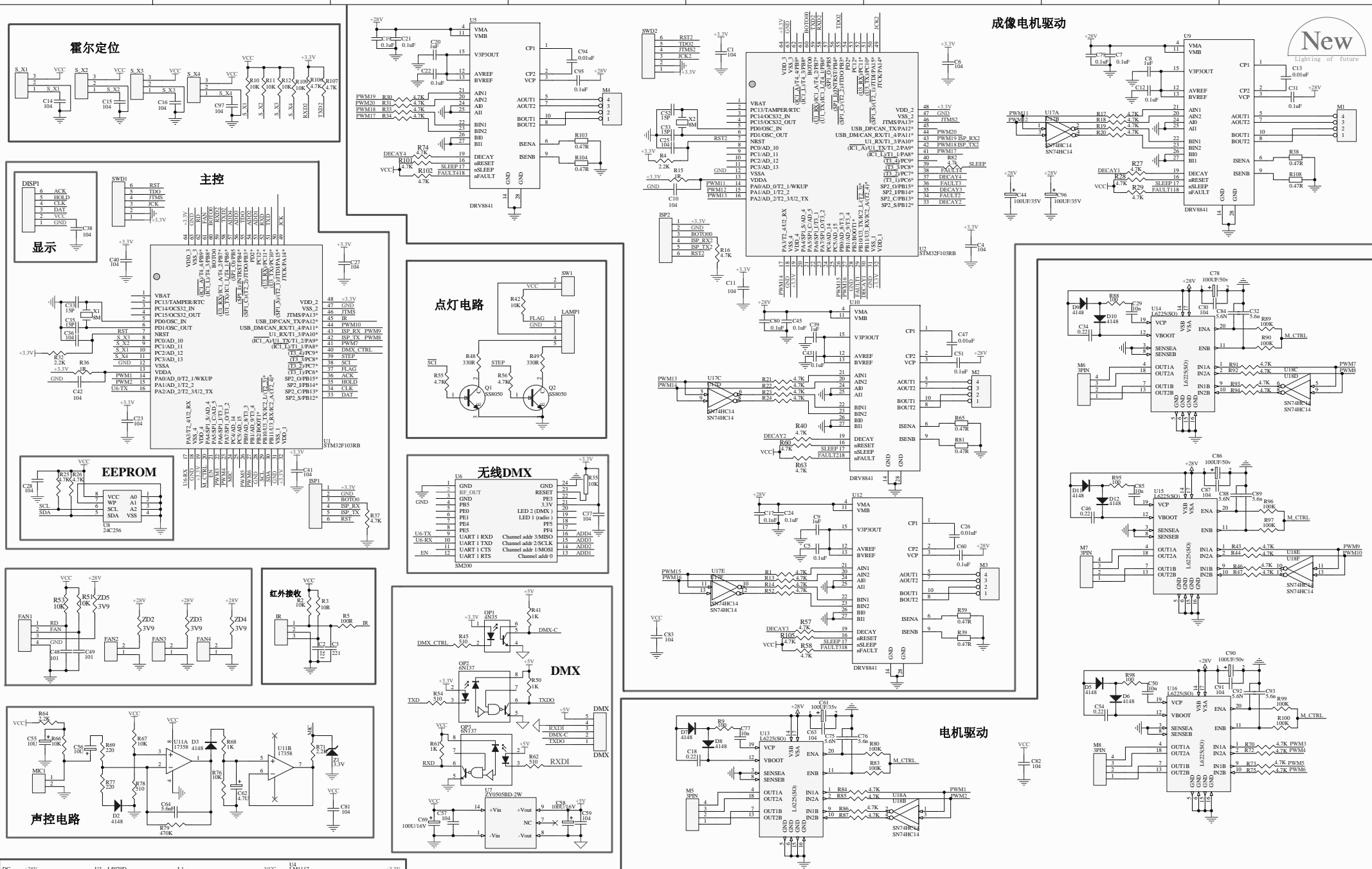

受控正本:	受控副本:	单位章:	承认:	名称:	备注说明:
			审核:	编号:	
			确认:	版次:	
			制图: Wincent	档案名: ADJ-LS2R-M.SCH	
			设计: Wincent	日期: 2014.03.18	文件编号:

成像电机驱动

电机驱动



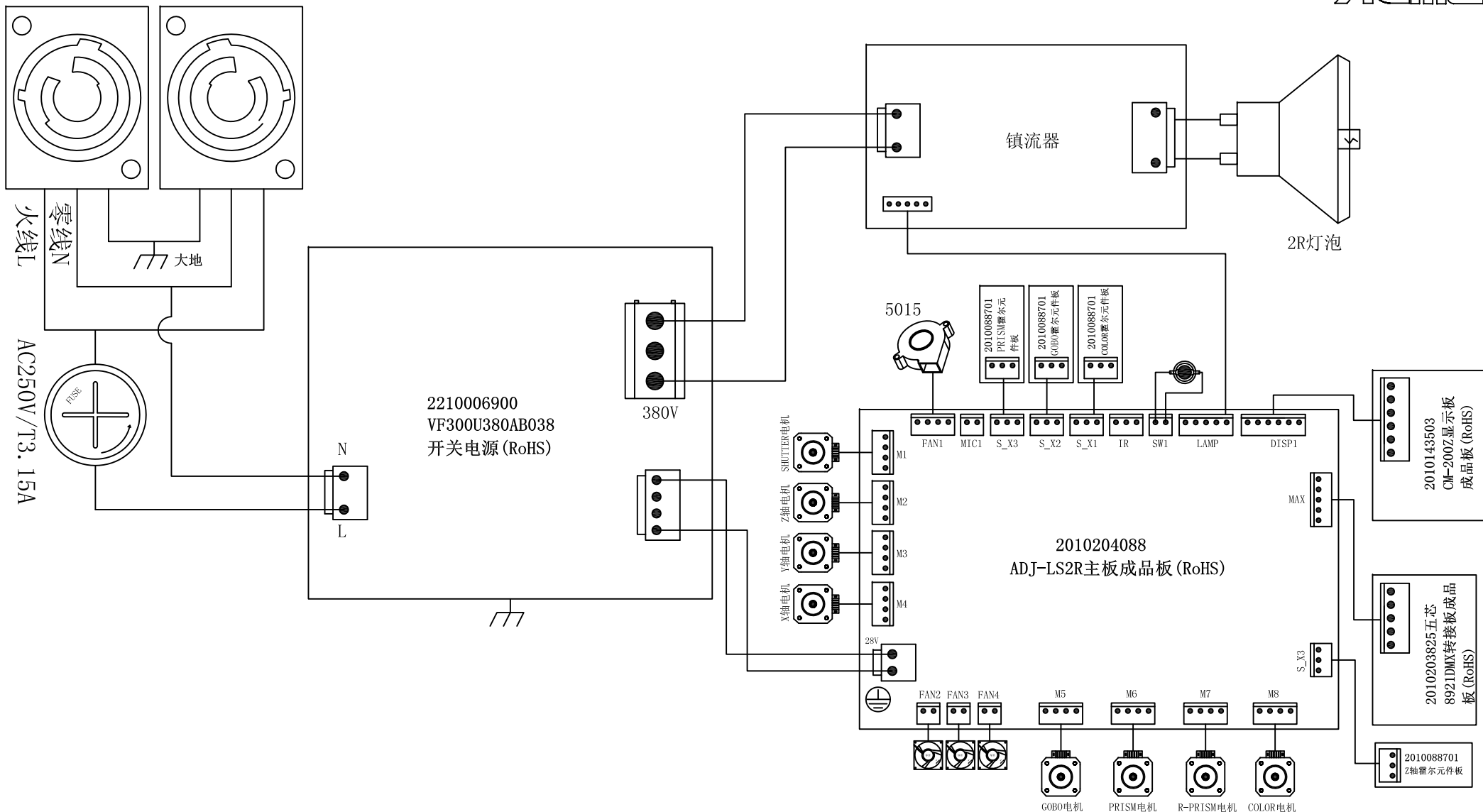

受控正本:	受控副本:	单位章:	承认:	名称: ELA-LS2R	备注说明:
			审核:	编号:	
			确认:	版次: A	
			制图: 黄证	档案名: ELA-LS2R-JX	适用机型: ELA-LS2R
			设计: 黄证	日期: 2014.06.10	第1页共1页